



## 10 Birchfield Crescent

Dodworth, Barnsley, S75 3NZ

Offers Around £160,000



Presented to the market with NO CHAIN and being situated in a highly sought after location, on a popular cul-de-sac, this well presented semi-detached home will not disappoint. To the front provides off street parking whilst to the rear is an enclosed garden with seating area and lawn. Close to shops, schools and junction 37 of the M1.

Don't miss out!



GROUND FLOOR

Entrance

Lounge

Dining Kitchen

FIRST FLOOR

Landing

Bedroom One

Bedroom Two

Bedroom Three

Bathroom

Outside

Area Map



Floor Plans

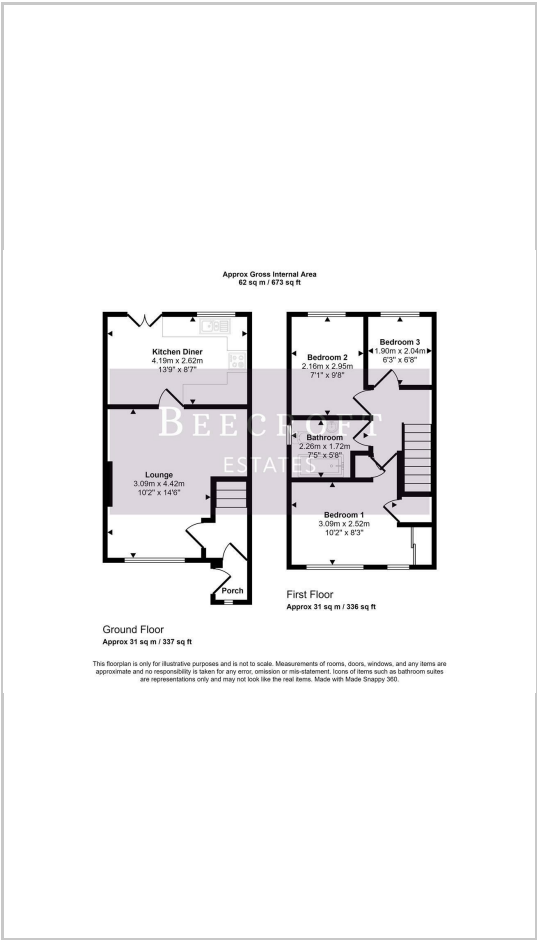

Energy Efficiency Graph

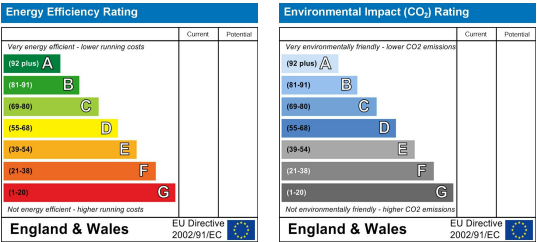

These particulars, whilst believed to be accurate are set out as a general outline only for guidance and do not constitute any part of an offer or contract. Intending purchasers should not rely on them as statements of representation of fact, but must satisfy themselves by inspection or otherwise as to their accuracy. No person in this firms employment has the authority to make or give any representation or warranty in respect of the property.